



The Calf's House  
Mesmear, Nr Polzeath



# The Calf's House

Mesmear, Nr Polzeath,  
PL27 6RA

The Calf's House is an enchanting single-storey barn conversion situated at Mesmear Farm, just a short drive to Polzeath. This stone property offers two bedrooms under a slate roof. Currently a successful holiday let, it benefits from a private patio and landscaped gardens as well as the use of a shared swimming pool. EPC Band D.

- Two double bedrooms, family bathroom.
- Open plan living area with vaulted ceilings, stylish well-equipped kitchen, and a wood-burning stove.
- Sunny patio area within a well-established landscaped garden.
- Within a short drive to The Point at Polzeath and Polzeath beach.
- Private parking.
- Currently a popular holiday let with a good letting history.
- In all approximately 793 sq. ft (73.7 sq. m)

Polzeath beach 1.6 miles, Daymer Bay 2.8 miles, Rock 3.5 miles, Wadebridge 6 miles, Bodmin Parkway Train Station 18 miles, Truro 32 miles, Newquay Airport 20 miles, Exeter 68 miles.

Viewings by appointment  
FREEHOLD (Holiday Restricted)





## OVERVIEW

Set within a collection of stone-built properties at Mesmeur, and surrounded by beautiful countryside, The Calf's House has been thoughtfully renovated. Offering comfortable accommodation with two bedrooms, a family bathroom and open plan living with a cosy wood burning stove for relaxed fireside moments. Outside, a sunny patio terrace provides a tranquil spot to enjoy meals or a sun downer.

## THE ACCOMMODATION

This single-storey property comprises:

Main entrance leading into | Open plan living room with fully equipped kitchen / breakfast bar and wood burning stove | Double bedroom with mezzanine store above | Family bathroom | Bunk room with second versatile mezzanine area.

## LOCATION

Nearby Polzeath is a favoured holiday and residential destination on the North Cornwall coast, with a vast expanse of sand, safe bathing and surfing and RNLI Lifeguard cover from Easter to October. The immediate area also offers wonderful walking country over National Trust land with superb coastal scenery. Nearby at Rock and Daymer Bay conditions are ideal for water sports as diverse as sailing, water skiing, canoeing and windsurfing, and the renowned St Enodoc Golf Club and The Point at Polzeath offer excellent 18-hole courses. Polzeath has several good places to eat and drink, including The Waterfront, The Oystercatcher and The Atlantic. The Point at Polzeath offers golf and leisure facilities including health club, tennis and paddle tennis courts and a bar and restaurant within walking distance of the property.

## OUTSIDE

The property enjoys a private, south-facing patio with countryside views. The garden is well established and has been landscaped with several low maintenance beds. The property benefits from use of the shared, heated swimming pool and jacuzzi, which it overlooks. There is private parking for two vehicles.

## SERVICES

Main's water and electricity. Private drainage. Calor Gas boiler with underfloor heating.





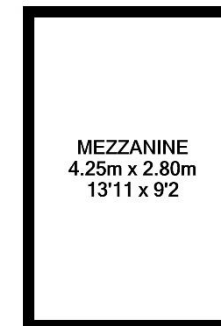
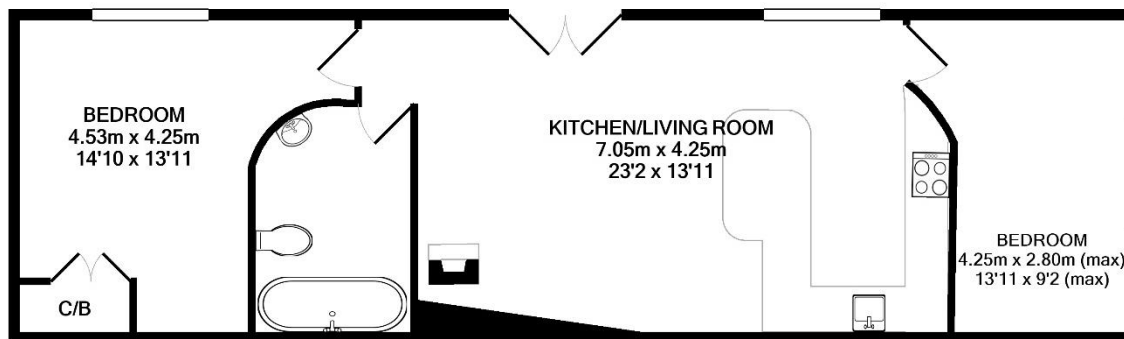

TOTAL APPROX. FLOOR AREA 73.7 SQ.M. (793 SQ.FT.)

Whilst every attempt has been made to ensure the accuracy of the floor plan contained here, measurements of doors, windows, rooms and any other items are approximate and no responsibility is taken for any error, omission, or mis-statement. This plan is for illustrative purposes only and should be used as such by any prospective purchaser. The services, systems and appliances shown have not been tested and no guarantee as to their operability or efficiency can be given  
Made with Metropix ©2019

**JB ESTATES**  
EST. 1971

Pavilion Building, Rock, Cornwall PL27 6JU  
01208 862601  
sales@johnbrayestates.co.uk  
www.johnbrayestates.co.uk

IMPORTANT NOTICE: JB Estates have prepared these details as a brief description of the property as they know it. These particulars do not form part of any offer or contract and must not be relied upon as statements or representations of fact. Any areas, measurements or distances are approximate. The text, photographs and plans are for guidance only and are not necessarily comprehensive. It cannot be assumed that the property has all necessary planning, building regulation, other consents or clear title and JB Estates will not have tested any services, equipment or facilities. No responsibility is taken for any travelling expenses incurred should the property prove to be inaccurately described or withdrawn. A buyer is advised to obtain verification on all matters from their solicitor.